

Wireless Synchronized Digital Clock (Double Side) (2.3")

TM682S-F-2-X



The POLMON Wireless Synchronized Digital Clock System is a perfect solution for a wide range of applications where accurate, synchronized time is required. All clocks display the same real time, whether in the office, factory, warehouse or canteen.

TM682S-F series clocks are designed for Ex-Zones. Clocks synchronized with master clock on RF network. Even if RF network fails they operate with inbuilt real time clock.

The clocks are designed for Pharma room applications with Flameproof Enclosure.

Features

- Synchronization with Master clock
- Work in stand - alone mode in case of network failure
- Bright, flicker - free seven segments LED display
- Dual Side Display
- Displays time in HH:MM Format
- Best suited for clean room application for EX-Zone IIA, IIB
- Tracking of clock health condition in HMI
- Indication of network failure with blinking display time
- 2.3" display visible up to 100 feet

Applications

- Pharmaceutical industry
- Ware House
- Factory
- Office
- Canteen
- Colleges etc

Network Architecture

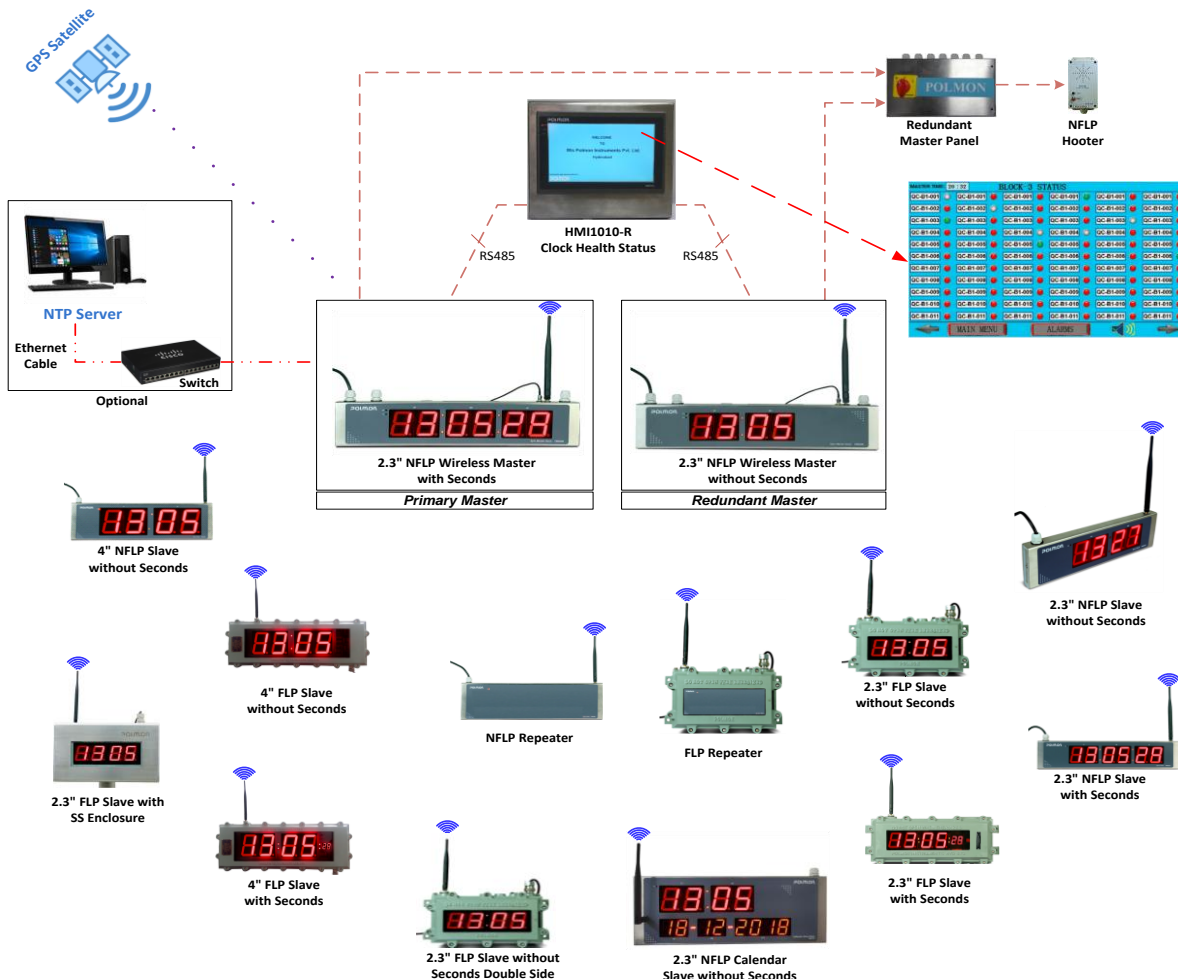

Specifications

Technical	
Model No	TM682S-F-2-X
Display	2.3"Seven Segment LED Display(RED)(Dual Side Display)
Time Format	HH:MM (24Hrs)
Accuracy	In Synchronization: Shows Master Clock Time Stand-alone: ± 2.0 min/year
Communication	RF Wireless
Time Synchronization	Every one minute
Power Supply	230Volts AC 50Hz, 10VA
Cable Entries	$\frac{3}{4}$ " ET -2No's
Cable Glands	To be Order separately
Cable Specifications	Power Supply: PVC Insulated 1 Sqmm X 3Core Armored cable

RF Communication	
Frequency	865Mhz to 867Mhz
Distance	1500 meters line of sight
Antenna Type	Dipole
Antenna Fixing	Instrument Plug type SMA end
RF Power output	+27dBm (500mWatt)
Physical	
Dimensions	431X210X110mm (Approx)
Enclosure material	Aluminum
Weight	5Kgs(Approx)
Mounitng	Hanging
Environmental	
Operating temperature	10-50°C
Humidity	10-95%RH, Non-condensing

Ordering Information for TM682S			
TM682S	X	X	X
Model No	External Enclosure	Display type	Relay Output
TM682S	R – NFLP SS Wall Mount	1 – Single Side	X – No
	F – FLP	2 – Double Side	1 – Yes
	M – NFLP Flush Mount		
	C – FLP IIC		

MECHANICAL DRAWING OF TM682S-F-2-X

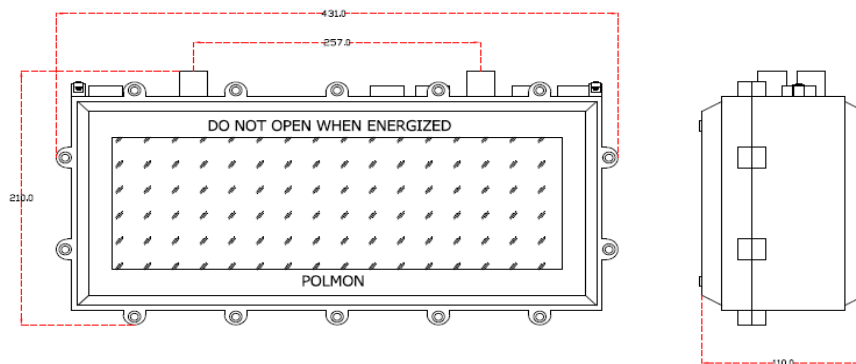

INSTALLATION OF TM682S-F-2-X

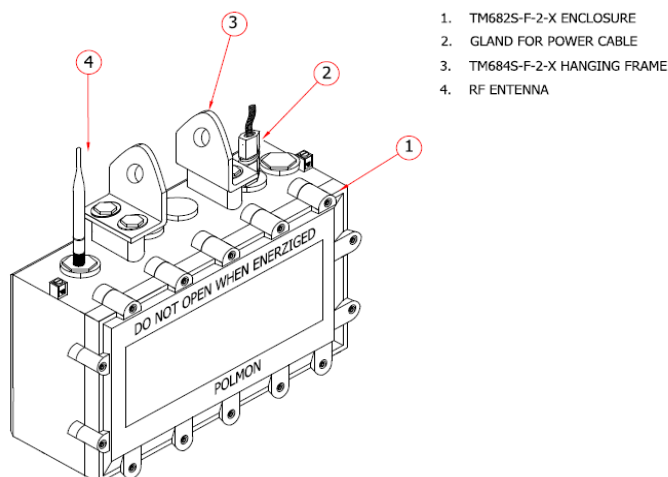

1. TM682S-F-2-X ENCLOSURE
2. GLAND FOR POWER CABLE
3. TM684S-F-2-X HANGING FRAME
4. RF ANTENNA