





Process Loop Analyzer

PLA50



The Process Loop Analyzer (PLA 50) features all the practical loop analysis functions in one compact & comprehensive unit. It is a one piece, easy to use instrument for the process field engineer. A wide range of activities in trouble shooting control loops / calibrating process instruments can be done with PLA 50.

Features

- High accuracy measurement of current, Voltage & Resistance
- High accuracy sourcing of Current & Voltage
- Flexible   (step) &   (ramp) Current / Voltage sourcing features to support wide range of field testing options
- Controlled output Current / Voltage with fine increment & decrement feature
- Provides programmable loop current option to source with Internal 24V power / loop 24V power
- Direct keys for MIN and MAX sourcing
- Direct measurement of loop current up to 24 mA
- Graphic LCD Display
- Power up 2-wire transmitters with 24V and measure up to 24 mA
- Process measuring and indicating with wide engineering units
- Built in functions to measure 2-wire, 3-wire & 4-wire RTD
- Loop continuity check with displaying resistance on the screen
- Works on 4 AA NIMH rechargeable batteries
- Compact, lightweight, rugged and reliable analyzer

Applications

- Calibrate Process Instruments
- Check 2 wire / 3-wire / 4-wire transmitters
- Check Control Valves
- Check RTDs
- Check loop continuity
- Testing loop functionality during installation

Specifications

Technical						
Current						
	Range	Resolution	Accuracy (Reference 22 ±5°C)	Temperature effect (<17 to >18°C)	Voltage burden	Battery life
Measure (mA)	4-20mA	0.001mA	±0.004mA	0.003% of range /°C	2V at 20mA	>18hrs
	0-20mA	0.001mA	±0.004mA			
	0-24mA	0.001mA	±0.004mA			
Sink (mA)	4-20mA	0.001mA	±0.004mA	0.003% of range /°C	2V at 20mA	>18hrs
	Loop Voltage Limit		36V DC			
Source (mA)	4-20mA	0.001mA	±0.004mA	0.003% of range /°C	2V at 20mA	>12hrs at 12mA
	0-20mA	0.001mA	±0.004mA			
	Loop drive capability		1000Ω at 20mA			
Loop 24V	4-20mA	0.001mA	±0.004mA	0.003% of range /°C	2V at 20mA	>12hrs at 12mA
	0-20mA	0.001mA	±0.004mA			
	0-24mA	0.001mA	±0.004mA			
Voltage						
Measure Volts	0-1V DC	0.0001V	±0.0004V	0.003% of range /°C		>18hrs
	0-5V DC	0.001V	±0.005V			
	1-5V DC	0.001V	±0.005V			
	0-10V DC	0.001V	±0.010V			
	2-10V DC	0.001V	±0.010V			
Input impedance: >1MΩ						
Source Volts	0-1V DC	0.0001V	±0.0030V	0.003% of range /°C		>18hrs
	0-5V DC	0.001V	±0.005V			
	1-5V DC	0.001V	±0.005V			
	0-10V DC	0.001V	±0.010V			
	2-10V DC	0.001V	±0.010V			
Load impedance: 10KΩ min						
Temperature (Pt-100)						
4-RTD Measurement	-200.0 to 500.0°C	0.01°C	±0.05°C	0.002% of range /°C		>18hrs
3-RTD Measurement	-200.0 to 500.0°C	0.01°C	±0.05°C	0.002% of range /°C		>18hrs
2-RTD Measurement	-200.0 to 500.0°C	0.01°C	±0.05°C	0.002% of range /°C		>18hrs
Loop continuity						
Continuity Check	000.0-099.9Ω, Display loop impedance with visual indication & beep sound 100.0-900.0Ω, Only displays loop impedance					
Physical						
Dimensions	170x115mm					
Weight	0.5Kg					
Environmental						
Operating Temperature	10-50°C					
Humidity	10-95% RH, Non-condensing					

Ordering Information for PLA50		
PLA50	X	X
<i>Model No</i>	<i>Enclosure Type</i>	<i>Future use</i>
PLA50	R – NFLP	X

MECHANICAL DRAWING OF PLA50

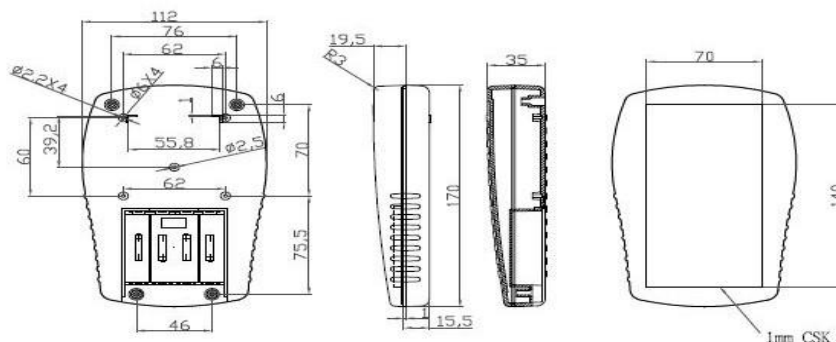

Head Office: POLMON INSTRUMENTS PVT.LTD
 (AN ISO 9001: 2015 Certified Company)
 "POLMON HOUSE" Nizampet Road, Kukatpally, Hyderabad-500085
 Ph No: 040-23053046, 23057308
 e-mail: polmon@polmon.com URL: www.polmon.com

All specifications are subject to change without notice.
 Doc. Ref. PLA50/270820/V1.0